

Mobile Unit Phlebotomy Services (MUPS)

Don't delay your healthcare

- getting important blood work has never been easier



Monmouth Medical Center Southern Campus is requesting that you schedule your lab test appointment, using Health Connect, an online Scheduling tool.

There are 2 ways to schedule your Lab testing appointment on Health Connect:

- You can go to Health Connect from your computer at: <https://healthconnect.rwjbh.org/hcweb>
- Search and download the RWJBH Health Connect App to your phone. Or use your phone's camera to scan the QR code below and download the RWJBH Health Connect APP to your phone. Once you are on the App, Register and go to DX Tests and COVID Treatment, select *Lab Procedure* and select your appointment location and date of service.

If you are having trouble finding the scheduling location or application we have agents that can assist you during this transition at 732-923-6800 option 4

Our phlebotomy teams are taking every precaution to keep our patients and staff safe, including:

- We will provide blood draw services at your Clubhouse for your safety and convenience
- For everyone's protection, appointments will be staggered for social distancing
- Staff will use strict hand hygiene practices and hand sanitizer will be available
- Social and physical distancing measures for everyone
- Please wear a mask, or a mask will be provided to you



600 River Avenue, Lakewood, NJ 08701

Phone: 732-363-1900

rwjbh.org/monmouthsouth

**Monmouth
Medical Center
Southern Campus**

**RWJBarnabas
HEALTH**

TO VIEW YOUR ED LABORATORY RESULTS

- 1) Go To <https://mychart.rwjbh.org/>
- 2) Sign Up Now

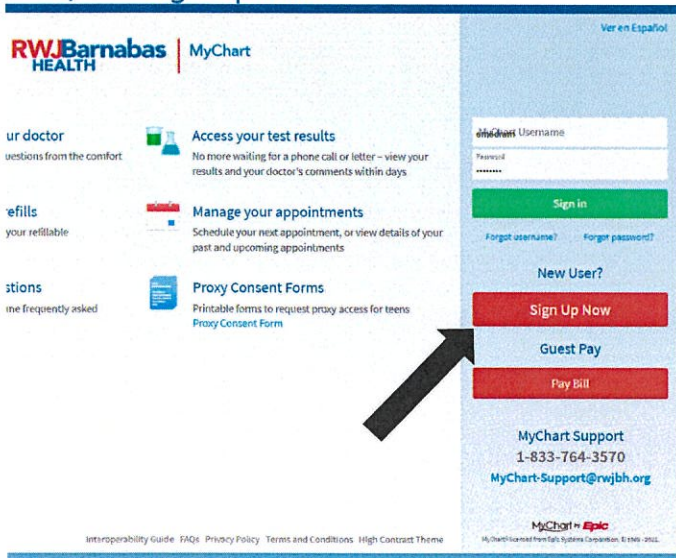

- 3) No Activation Code – Sign up Online

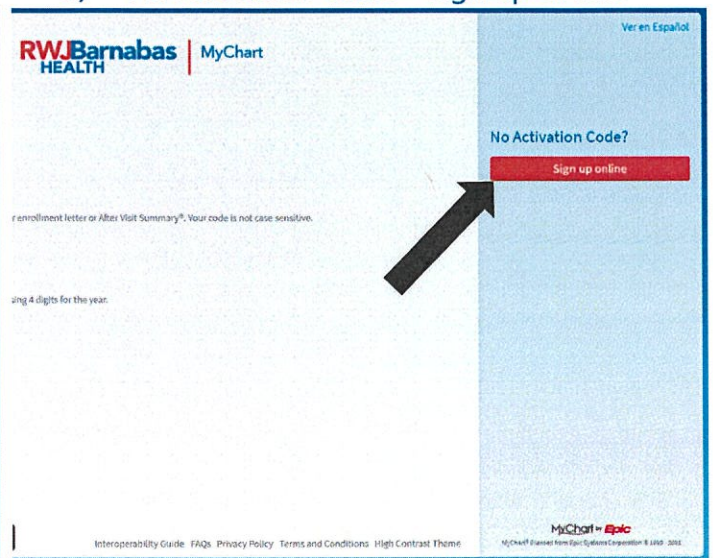

OR Download the MyChart app

Go to the App Store or Google Play Store and search for "MyChart."

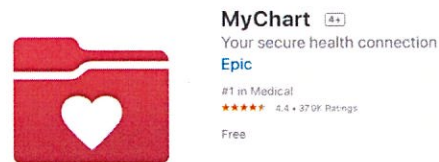

- 1) Open APP, select RWJBarnabas Health from the list of organizations. You can search for RWJBarnabas Health by name, state, or ZIP code.

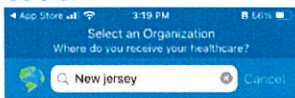

Penn Medicine

myPennMedicine

Prime Healthcare

MyChart

RWJBarnabas HEALTH

MyChart

SANFORD HEALTH PLAN

MyChart

University HOSPITAL

- 2) Sign up now. Or Select NO ACTIVATION CODE (android)

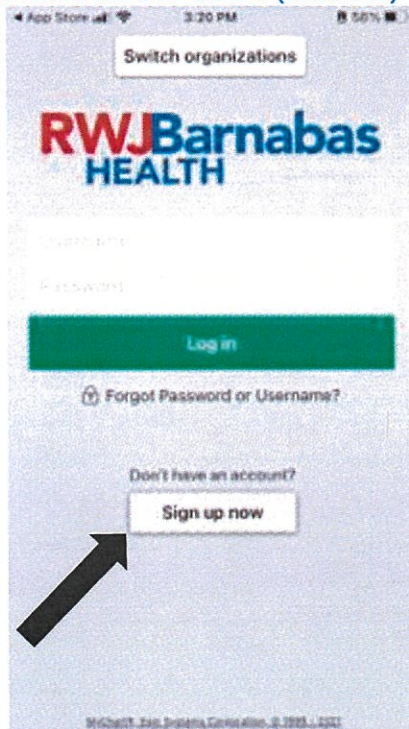

- 3) Answer Demographic and Security Questions

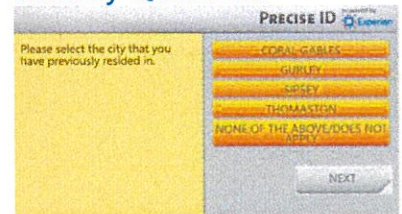

- 4) Access TEST RESULTS below.

