

# DUO 2FA for Care Link

Duo is a 2-factor authentication (2FA) solution, for secure login to the RWJBH network and applications. **Two-factor authentication** adds a second layer of security, keeping your account secure even if your password is compromised. With Duo Push, you'll be alerted right away (on your phone) if someone is trying to log in as you.

## How it Works



1. Click either the Email option or the mobile option, and the code will be sent appropriately for validation.

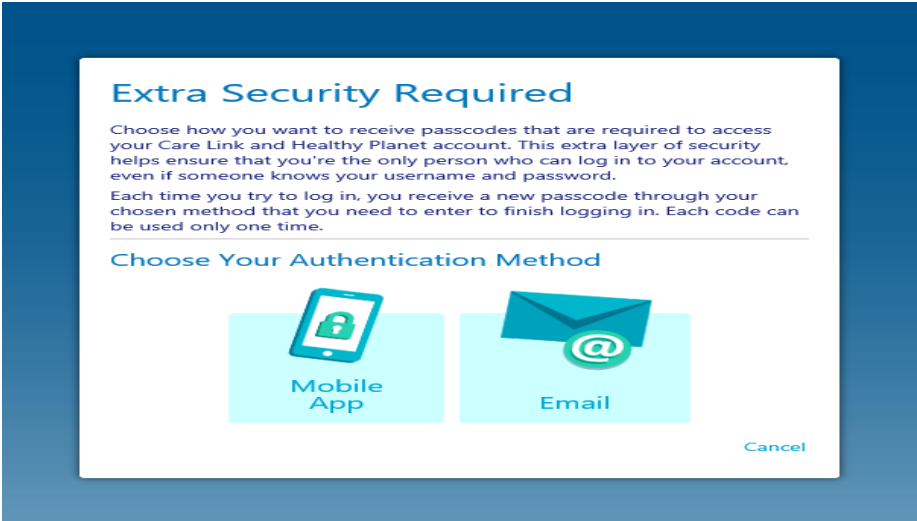

## DUO Via Email

2. You will receive an email notification with the verification code (below), to the email supplied in the request.
3. Enter the verification code into the field and click Verify.

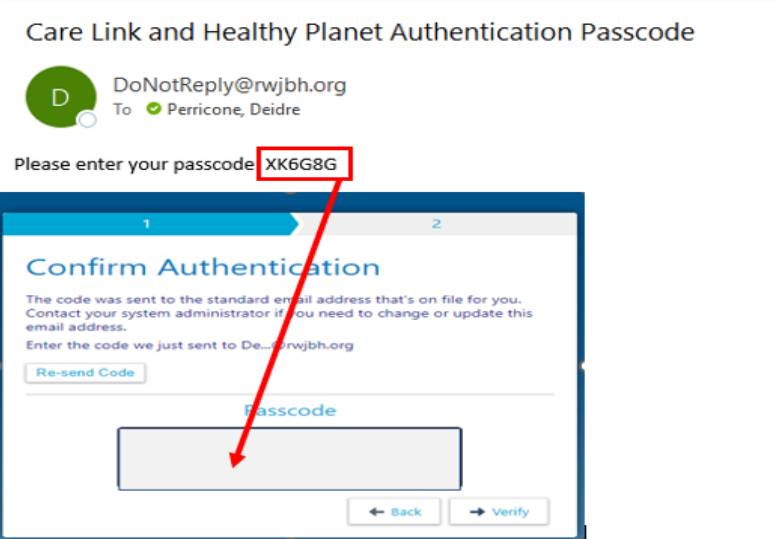

## DUO via Mobile Set-Up

- Go to the DUO icon on your phone if used for the AD account. **Click Add.**
- Click **Use QR Code** to take a photo of the QR Code that displays in Care Link.

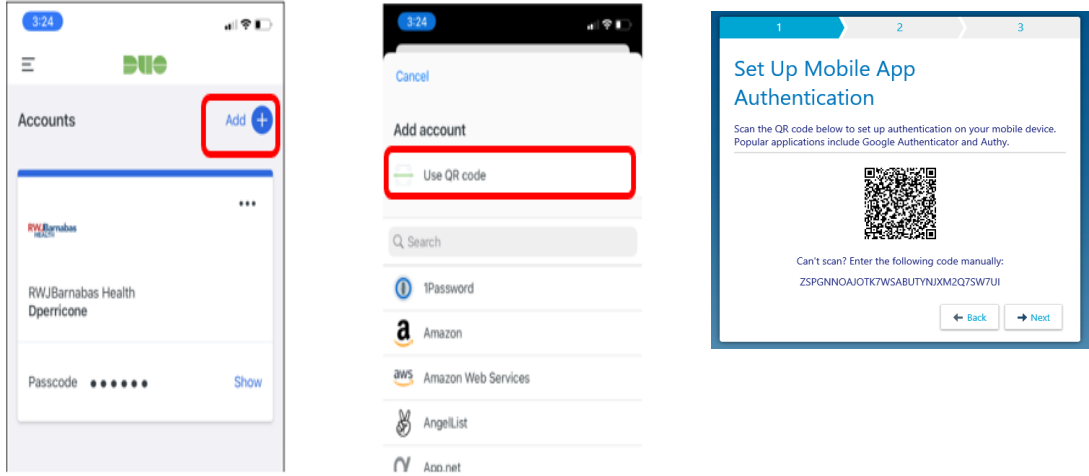

- Enter the name of the application (Care Link) as the Third Party.
- Now you will see 2 accounts; the one you previously set up for the AD account (**RWJBarnabas Health**), and the one that was just created for Care Link.
- **Enter the code** from the DUO app and click Remember Me.

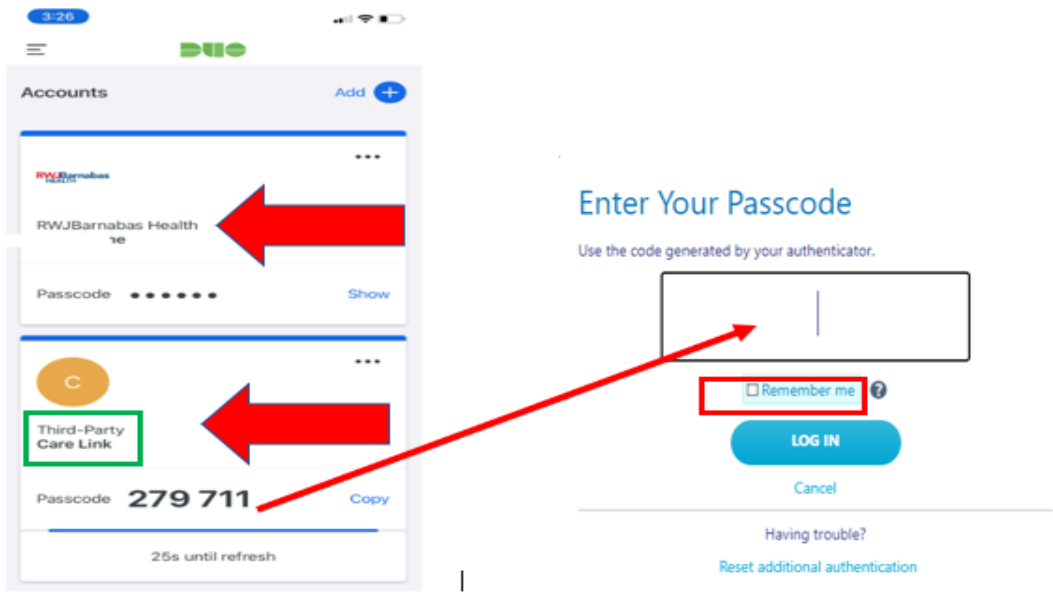

- After the set-up, when you verify via mobile, you will be prompted for the verification code.
- Enter the code** from the DUO app to access Care Link.

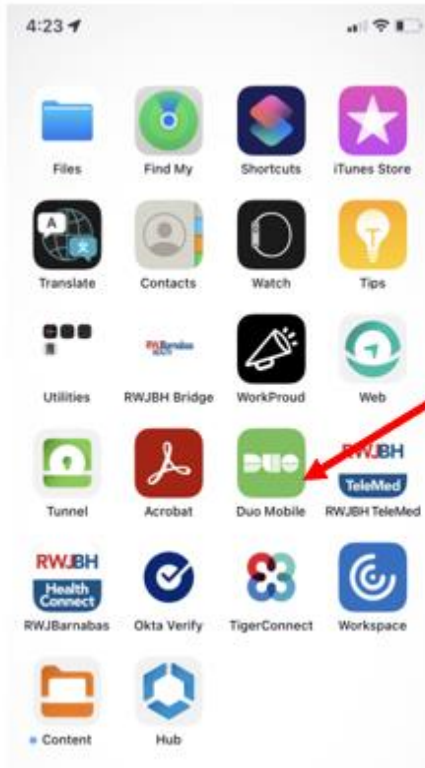

For both email and mobile options, **record the reset code**. With this code you can enter it to change the method for authentication.

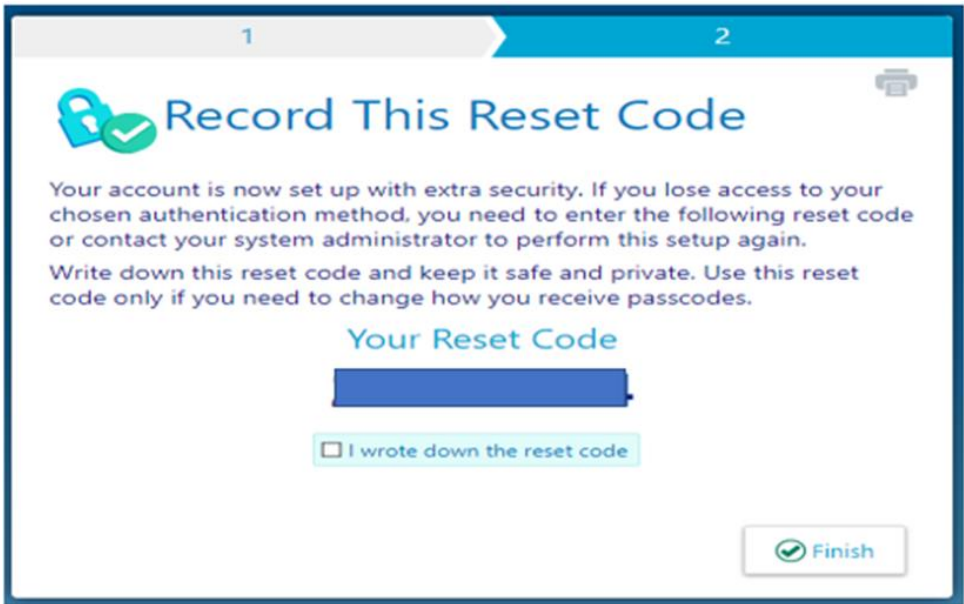

<b>Version #</b>	<b>Purpose of Change</b>	<b>Author</b>	<b>Date of Change</b>
<b>1.0</b>	Initial Creation	Klaudia Wadolowska	1/26/23
<b>1.1</b>		Deidre Perricone	1/30/23