

First Floor

- North Tower
- Lakefront Tower
- Central Building
- South Building
- Outpatient Building
- East Building

- ENTRANCE
- INFORMATION
- ELEVATOR
- RESTROOM
- STAIRWAY
- ATM

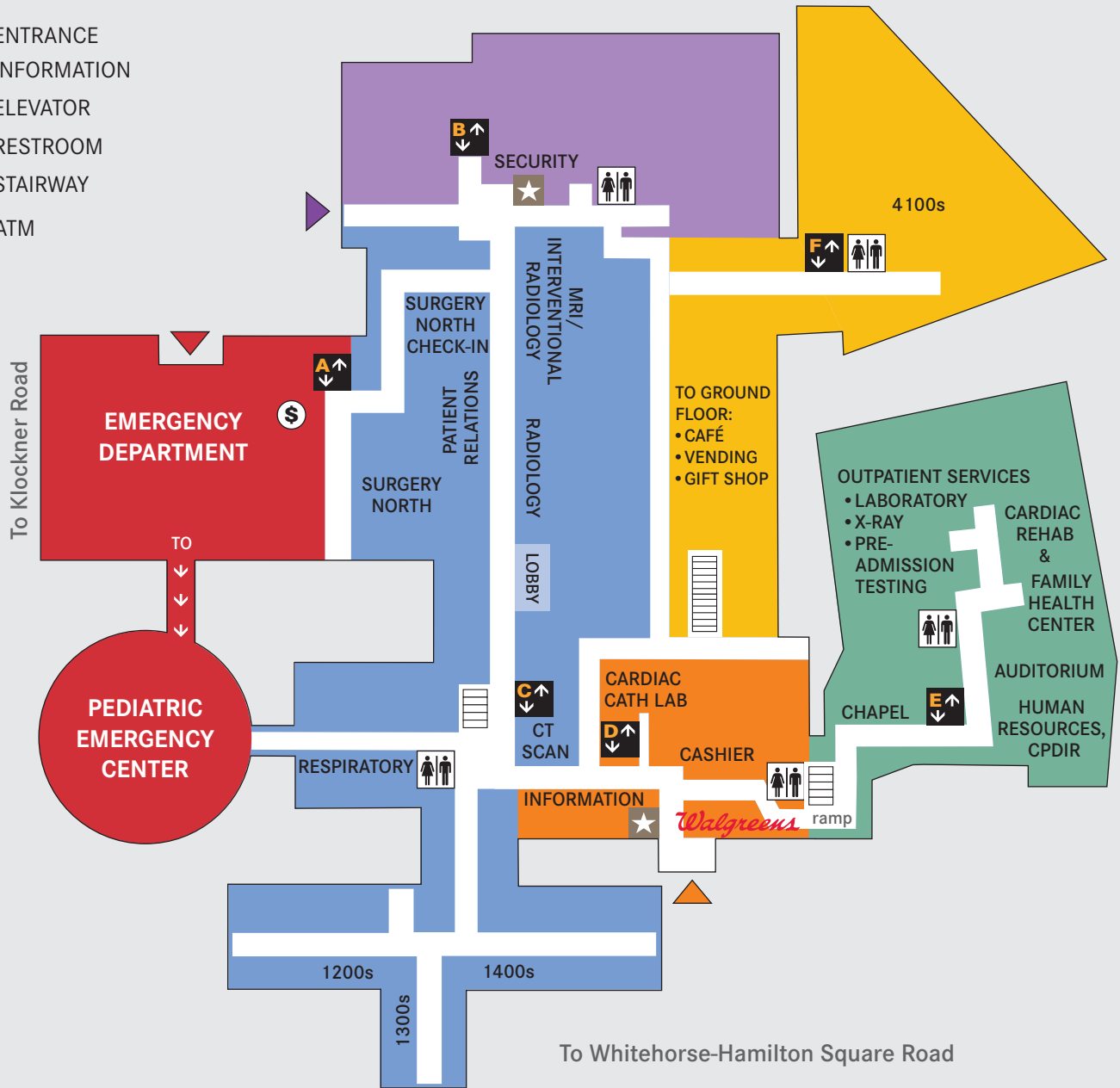

ELEVATOR GUIDE:

Elevator A to: 2500s (Intensive Care), 3500s (Telemetry North), Emergency Department, Medical Records

Elevator B to: Administration, Main Lab/Lab Records, Security

Elevator C to: 1200s to 1400s (Telemetry Central)

Elevator D to: 2100s (2 South - Cardiology, Neurology, Ultrasound, Vascular Lab), 3100s (Hospice), Café, Diabetes

Elevator E to: Auditorium, Cardiac Rehabilitation, Center for Professional Development, Innovation and Research, Chapel, Endoscopy, Family Health Center, Financial Counseling (Charity Care), Foundation, Laboratory, Pre-Admission Testing, Registration, Surgery South, Women's Center, Wound Center, X-ray

Elevator F to: 4100s, 4200s, Café